

**BSR**

**Balkan Society of Radiology**



# **XVIII CONGRESS OF BALKAN SOCIETY OF RADIOLOGY**



**19-20 October, 2023**  
**Belgrade, Serbia**



M A G N A  
P H A R M A C I A

GE  
Distributor  
GE Healthcare



SIEMENS  
Healthineers



Amicus  
a Swixx BioPharma company

ALPHA IMAGING  
consulting, engineering & sales



SHIMADZU  
Excellence in Science



LIFE FROM INSIDE



EDENTA®  
RADIOLOGIE DENTARA

mark medical™  
empowering healthcare

TELMEDE SANOMED

APTUS

AB TRADE  
SVET U TREĆOJ DIMENZIJI

austroline



MEDICTA  
softver za diktiranje

Dear BCR members,  
Dear colleagues,

After the long interruption of our activities due to the COVID epidemic, which made it impossible to see each other live, we are extremely happy to welcome you to this year's XVIII Balkan Congress of Radiology!

As was decided by the Executive Committee and, at the suggestion of our colleagues from Serbia, it will be held in Belgrade, and this year, the Balkan Congress will be merged with the Serbian National Radiology Congress. And this, the 18th congress will be an excellent opportunity for networking, learning, and building meaningful connections between Balkan radiologists with the high quality of the presented scientific reports.

We are confident that this Congress will provide a unique platform for networking, learning, and building connections with colleagues. With a dynamic agenda that includes keynote sessions, panel discussions, and symposia, we invite you to join us for an engaging and inspiring experience. The topics truly reflect the current trends, recent advances, and new, cutting-edge approaches in radiology. This congress has a rich history and has played a significant role in the advancement of radiology in the Balkans, gathering radiology professionals from across the Balkans and beyond.

Additionally, we are going to host ESOR Visiting Professorship for those who have a special interest in neuroradiology and general radiology. Experts in neuroradiology will provide lectures on state-of-the-art topics, accompanied by interactive presentation of cases, a pattern that has been proven to be attractive and already recognized as very efficient.

With this address, we once again express our great joy that we will gather to exchange scientific achievements and strengthen Balkan radiologists' once again gather to exchange scientific achievements and strengthen Balkan radiologists' already traditionally friendly contacts. And this is one of the main goals of our organization – to unite the radiological community in this small geographical part of Europe, but rich in history and traditions.

We hope you are as excited as we are to meet in person again, improve and share knowledge, and enjoy your stay in Belgrade!

See you in Belgrade!

Prof. Milan Totev  
President, BSR

Prof. Ružica Maksimović  
President, BCR 2023

## **President, BSR**

Milan Totev

## **President, BCR 2023**

Ružica Maksimović

## **Executive Committee**

Milan Totev  
Nicholas Gourtsoyiannis  
Ružica Maksimović  
Nevra Elmas  
Milos Lucic  
Dragos Negru  
Cem Calli  
Nikoleta Traikova  
Nadica Mitreska  
Zulejha Merhemic  
Charina Triantopoulou

## **Program Planning Committee**

Charikleia Triantopoulou, Greece,  
Chairwoman  
Andras Palko, Hungary  
Dragos Negru, Romania  
Vesna Sarajlic, Bosnia and Herzegovina  
Sukru Mehmet Erturk, Turkey  
Dragana Djilas, Serbia  
Efrosini Papadaki, Greece  
Svetlana Antevska Grujevska, FYROM  
Dora Zlatareva, Bulgaria

## **Local Organizing Committee**

Ružica Maksimović  
Miloš Lučić  
Dragan Mašulović  
Ruža Stević  
Viktor Till  
Sanja Stojanović  
Dragan Stojanov  
Dragan Sagić  
Radiša Vojinović  
Dragan Dulović  
Biljana Marković-Vasiljković  
Jovica Šaponjski  
Milan Mijailović  
Silvija Lučić  
Jelena Kovač Djokić  
Milena Spirovski  
Siniša Ristić  
Viktorija Vučaj Ćirilović

## **Secretary General of BCR 2023**

Miloš Gašić

1. **MUSCULOSKELETAL RADIOLOGY**
2. **CHEST RADIOLOGY**
3. **CARDIOVASCULAR RADIOLOGY**
4. **INTERVENTIONAL RADIOLOGY – VASCULAR**
5. **INTERVENTIONAL RADIOLOGY – NON-VASCULAR**
6. **INTERVENTIONAL NEURORADIOLOGY**
7. **UROGENITAL RADIOLOGY**
8. **NEURORADIOLOGY**
9. **GASTROINTESTINAL RADIOLOGY**
10. **BREAST RADIOLOGY**
11. **PEDIATRIC RADIOLOGY**
12. **ONCOLOGIC IMAGING**
13. **HEAD AND NECK IMAGING**
14. **EMERGENCY RADIOLOGY**
15. **JUNIOR SESSION**

Belgrade is the capital and largest city of Serbia, situated at the confluence of the Sava and Danube rivers and at the crossroads of the Pannonian Plain and the Balkan Peninsula. It is one of the oldest continuously inhabited cities in Europe. Today population of the Belgrade metropolitan area is 1.68 million.

## **HISTORY**

The first farming people to settle in the region are associated with the Neolithic Starčevo culture in the 6-7th millennium BC. One of the most important prehistoric cultures in Europe, the Vinča culture, evolved within the Belgrade area and is best known for the earliest known copper metallurgy in Europe and a proto-writing. Evidence of early knowledge of Belgrade's geographical location can be found in a variety of ancient myths and legends. The ridge overlooking the confluence of the Sava and Danube rivers is described in the epic poem of Jason and the Argonauts. It was inhabited by Thraco-Dacians and Celts and later conquered by the Romans and in the 6th century by the Slavs.

Belgrade served as the capital of the medieval Serbian Despotate and evolved into one of the most strategically important cities during the Ottoman–Habsburg wars. The city has been battled more than 100 times and besieged many times over centuries. Belgrade has become the development and cultural center of Southeast Europe, hosting numerous international events. It also is home to the University Clinical Centre of Serbia, one of the hospital complexes with the largest capacity in the world, the Church of Saint Sava, one of the largest Orthodox church buildings, as well as residence of a novelist Ivo Andrić, Nobel laureate, and Novak Đoković, the greatest tennis player of all time.

## **CULTURE & SCIENCE**

Belgrade has a lot of nationally important arts and scientific institutions: the Serbian Academy of Sciences and Arts (founded in 1886), the National Library of Serbia (1832), the National Museum of Serbia (1844), the National Theatre (1869), and the University of Belgrade (1905; as Grande école in 1808). The most famous museums in Belgrade are: the Historical Museum of Serbia, Ethnographic Museum, Museum of Contemporary Art, Nikola Tesla Museum, Museum of Vuk and Dositej, Museum of Yugoslavia, Military Museum.

## **LANGUAGE**

The official language is Serbian. The official alphabets are Cyrillic and Latin. Many people in Serbia, especially congress staff and participants, are fluent in English.

## **CURRENCY**

The official currency of the country is the Serbian Dinar (RSD). Foreign currencies can be exchanged at exchange offices and banks.

## **TIME ZONE**

Belgrade and Serbia are in the CET (Central European Time) zone – UTC+1. In summer the Daylight Saving Time (DST) moves it to CEST – UTC+2.

## **CLIMATE & WEATHER**

Belgrade has a moderate continental climate, with four seasons and uniformly spread precipitation. Take a look at the weather forecast for the week of Congress here.

## **WATER**

Tap water in Belgrade is safe to drink. In addition, many bottled water brands offer regular, mildly carbonated, or highly carbonated water.

## **WORKING HOURS**

Most shops and grocery stores work usually from 8 AM to 9 or 10 PM, but there are others that work 24h. Large shopping malls are open from 10am until 10 PM on business days and weekends too. Banks and offices have standard 9 AM to 5 PM working hours. Most of them have ATMs (cash machines).

## **EMERGENCY**

In case of emergencies during the Congress, please contact the staff at the registration desk. In case of emergencies in the hotel, please contact your hotel reception for first aid service.

- Police Department: 192
- Fire Department: 193
- Medical emergencies: 194

## **AIRPORT**

Belgrade Nikola Tesla Airport (BEG)

Surčin, 18 km (11 miles) west of downtown Belgrade

Address: Belgrade 59, 11180, SERBIA

Phone: +381 11 209 4000

Mini buses are available to go and come back to Belgrade Airport from Slavija Square, priced 400 RSD (3.4 €) one-way. All vehicles are fully equipped and modern. There are also a few regular public transport lines.

## **MOTORWAYS**

Belgrade is located along the Pan-European corridors VII and X. E70 directly connects the city with Slovenia and Croatia, as well as Romania and Bulgaria. E75 connects Belgrade with Hungary, as well as North Macedonia and Greece.

## **RAILWAY**

Belgrade is directly connected with the international train line to Bar (Montenegro) via Podgorica (Montenegro) and Ljubljana (Slovenia) via Zagreb (Croatia). Due to reconstructions, the timetable should be checked regularly.

The Four Star Hotel M is one of the Belgrade leading business and conference hotels. The hotel is conveniently located, next to the Byford's Forest, just a 5 minutes bus ride to city center and Belgrade Fair, and 20 minutes to the International Airport Nikola Tesla.

The advantages of hotel are good connection with main roads, airport and city centre, free internet, free hotel parking and stay in protected environment. Each of 180 elegantly decorated rooms are designed for a creative work ambience with large desks, free high-speed and wireless internet. Functionally equipped rooms, comfortable beds and work area will provide you with a quality rest and prepare you for another working day.

## **REGISTRATION**

The age limit for registration as a resident is 35 years.

The specified amounts of participation in the congress will be strictly observed depending on the date of payment. To this account number, the registration fee for participation in the congress can be paid in dinars against the value at the middle exchange rate on the day of payment.

The registration fee includes:

- Participation in scientific sessions
- Congress material
- Coffee and snacks during breaks
- Networking and get together



	Early fee (to 15.9.2023.)	Fee (15.9 – 10.10.2023)	on site
Non-members of URS / ESR	150,00 €	170,00 €	190,00 €
Members of URS / ESR	120,00 €	140,00 €	160,00 €
Residents	70,00 €	90,00 €	110,00 €
Radiologic technologists	50,00 €	70,00 €	80,00 €

### **REGISTRATION FEES FOR ESOR VPP:**

Non-members of URS / ESR	85,00 €
Members of URS / ESR	65,00 €
Resident	35,00 €

Further information are available on  
**bcrad2023@gmail.com.**

**Please contact the following email address for any additional information related to registration:**

Contact for financial affairs:

Tatjana Todorović Kolić

tatjana@gorrri.net

Payment in local currency – dinar RSD

265-1620310003867-10

Foreign currency

RS35265100000017367028

SWIFT: RZBAATWW

**For any further information regarding acomodation and registration, kindly contact:**

TCA TRAVEL AGENCY

Address: Dr Dragoslava Popovica 15

Belgrade, Serbia

Phone: +381 11 3238 514

Mobile: +381 63 241787 Marija Stevanović

Ruzica Vukosavljević

Director +381 63 300719 Katarina Kovačević

e-mail: tca@beotel.rs

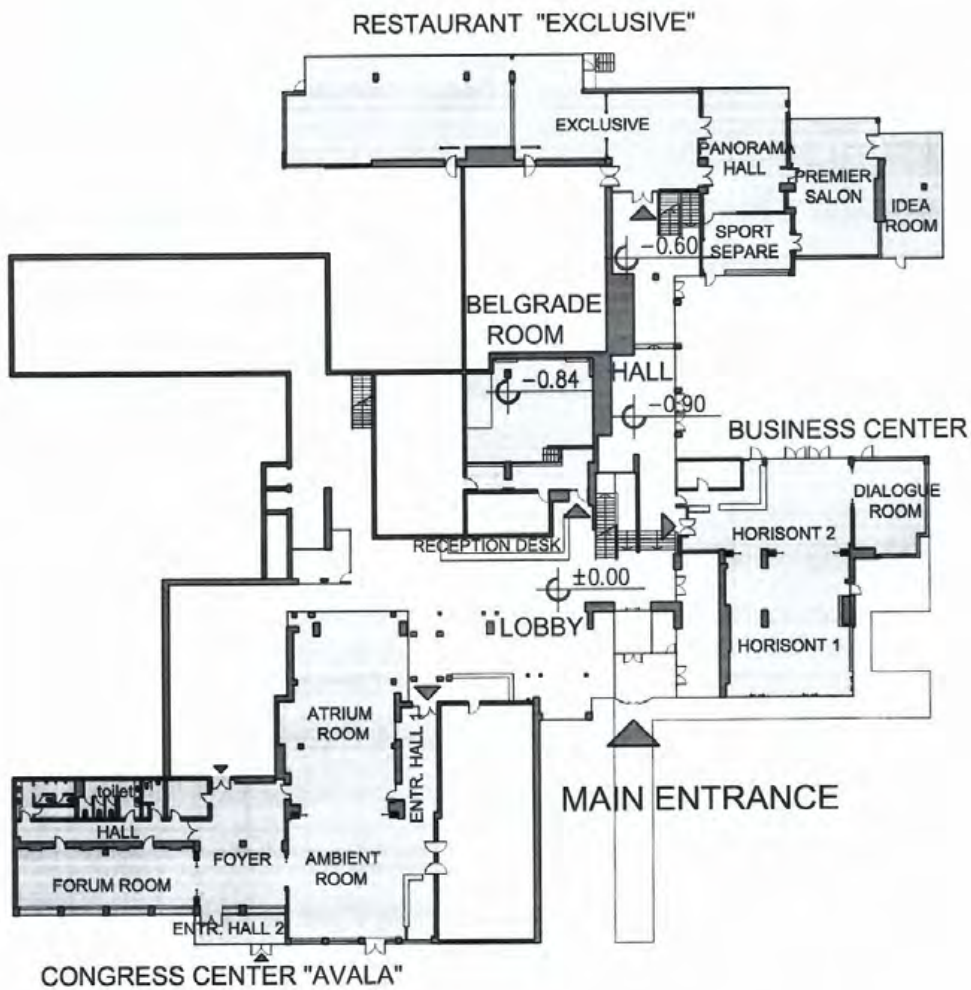

RESTAURANT "EXCLUSIVE"	total area 542.00 m2
BUSINESS CENTER	total area 270.00 m2
CONGRESS CENTER "AVALA"	total area 535.00 m2
BELGRADE ROOM	total area 111.00 m2

**THURSDAY 19.10.2023**

	Hall ATRIUM	Hall HORIZONT	Hall BEOGRAD
08.30-10.00	Focus session I Interventional radiology in treatment of liver tumors with interactive case discussion	Paediatric Radiology	Musculoskeletal Radiology I
10.00-11.30	Hepatobiliary system I	Breast Imaging I	Urogenital Radiology I
12.00-13.00	Opening Ceremony Honorary Lectures Moderator: Prof. N. Gourtsoyiannis (GR), Prof. Milan Totev (BG), Prof. Ružica Maksimović (RS) “Mentorship in the era of AI”- Prof. N. Gourtsoyiannis (GR), The History of the Future: AI & Radiology, Milos. A. Lučić (RS)		
13.00-14.00	Welcome Cocktail		
14.00-15.30	Abdominal Radiology	Interventional Radiology I	Scientific Presentations Interventional, Musculoskeletal and neuroradiology
15.30-17.00	Neuroradiology I	Cardiovascular Radiology	Scientific Presentations Abdominal and Uroradiology
17.00-17.30	Break		
17.30-19.00	Neuroradiology II	Oncology Imaging I	Scientific Presentations Breast, Chest imaging, Head and Neck
19.00-20.00	BSR Executive Committee Meeting & General Assembly		
21.00	Get together and Networking		

**FRIDAY 20.10.2023**

	Hall ATRIUM	Hall HORIZONT	Hall BEOGRAD
08.00-09.30	Chest Imaging	Understanding Imaging Fundamentals	Head and Neck Radiology
09.30-11.00	Focus Session II Prostate Carcinoma - What Should I Know?	Musculoskeletal Radiology II	Emergency Radiology
11.00-11.30	Break		
11.30-13.00	Hepatobiliary Radiology II	My Most Challenging Cases	Interventional Radiology II
13.00-14.00	Break		
14.00-15.30	Breast II	Focus Session III Lung Carcinoma - What Should I Know?	Urogenital Radiology II
15.30-17.00	JFR - An Ordinary Day at a Department of Radiology	Hands on in MSK	Oncology Imaging II
17.30-18.30	Closing Ceremony and Awards		



**FINAL PROGRAM**



**THURSDAY, OCTOBER 19, 2023** **HALL ATRIUM****08.30-10.00 FOCUS SESSION I - INTERVENTIONAL RADIOLOGY IN TREATMENT OF LIVER TUMORS WITH INTERACTIVE CASE DISCUSSION****MODERATORS:**

DRAGAN MAŠULOVIĆ (RS), DANIEL GALUN (RS)

**16. LOCORETINAL THERAPY OF LIVER TUMORS**

DRAGAN MAŠULOVIĆ (RS)

**17. WHAT DOES A SURGEON EXPECT FROM A RADIOLOGIST?**

DANIEL GALUN (RS)

**18. THERMAL ABLATION IN TREATMENT OF LIVER TUMORS**

ALEKSANDAR FILIPOVIĆ (RS)

**19. TACE IN THE TREATMENT OF LIVER TUMORS**

MILOŠ ZAKOŠEK (RS)

**20. INTERVENTIONAL RADIOLOGY IN TREATMENT OF MALIGNANCIES OF HILAR REGION**

DUŠAN BULATOVIĆ (RS)

**21. INTERVENTIONAL RADIOLOGY IN TREATMENT OF LIVER TUMORS - OUR EXPERIENCE**

ALEKSA IGIĆ (RS)

 **HALL HORIZONT****08.30-10.00 PAEDIATRIC RADIOLOGY****MODERATORS:**

N. MITRESKA (RNM), POLINA PAVIĆEVIĆ (RS)

**1. PAEDIATRIC LUNG ULTRASOUND-BETWEEN SKEPTICISM AND (OVER) ENTHUSIASM**

JOVAN LOVRENSKI (RS)

**2. MRI OF THE FETUS: AN OVERVIEW**

CORINA BANU (RO)

**3. MRI/RADIOLOGIC EVALUATION OF TRANSPOSITION OF GREAT ARTERIES**

SERÇİN (BAŞ) ÖZKÖK (TR)

**4. SHOULD I SAY OR SHOULD I NOT-MISSINTERPRETATION OF THE MOST COMMON NORMAL VARIANTS IN CHILDREN**

TIJANA RADOVIĆ (RS)

**5. THE ROLE OF ULTRASOUND IN PAEDIATRIC EMERGENCIES**

IVANA DAŠIČ (RS)

 **HALL BEOGRAD**
**08.30-10.00 MUSCULOSKELETAL RADIOLOGY I****MODERATORS:**

REMIDE ARKUN (TR), GORAN ĐURIČIĆ (RS)

**1. IMAGING OF ATRAUMATIC MUSCLE DISORDER**

ANESA ČENGIĆ (BIH)

**2. IMPINGEMENT SYNDROMES**

REMIDE ARKUN (TR)

**3. WHAT THE MRI CAN TELL US ABOUT LESIONS CAUSED BY EXCESSIVE KNEE USAGE IN YOUNG PHYSICALLY ACTIVE PEOPLE**

GORAN ĐURIČIĆ (RS)

**4. ANTERIOR KNEE PAIN**

VESNA NJAGULJ (RS)

 **HALL ATRIUM**
**10.00-11.30 HEPATOBILIARY RADIOLOGY I****MODERATORS:**

STAVROS EFREMIDES (GR), RUŽICA MAKSIMOVIĆ (RS)

**1. MR CONTRAST MEDIA - SPONSORED BY BAYER**

RUŽICA MAKSIMOVIĆ (RS)

**2. DIFFUSE LIVER DISEASES**

SUKRU MEHMET ERTURK (TR)

**3. MRI OF CIRRHOTIC NODULES. THE GOOD, THE BAD AND THE UGLY**

EVANGELOS ALEXIOU (GR)

**4. LIVER PSEUDOLESIONS: MR IMAGING FEATURES**

JELENA ĐOKIĆ KOVAČ (RS)

**5. CEUS IN FOCAL LIVER LESIONS**

VASILEIOS RAFAILIDIS (GR)

 **HALL HORIZONT**
**10.00-11.30 BREAST IMAGING I****MODERATORS:**

NIKOLAOS DIMITROPOULOS (GR), DRAGANA DJILAS (RS)

**1. BREAST CANCER SURVEILLANCE IN HIGH RISK WOMEN ?**

YASUO NAKAJIMA (JP)

**2. AI IN DIGITAL MAMMOGRAPHY AND BREAST TOMOSYNTHESIS**

NIKOLAOS DIMITROPOULOS (GR)

**3. BREAST IMAGING: BEYOND THE DETECTION**

DRAGANA DJILAS (RS)

**4. CHALLENGES IN BREAST IMAGING**

DRAGANA BOGDANOVIĆ-STOJANOVIĆ (RS)

**5. RARE BREAST LESIONS**

DRAGANA ROGANOVIC (BiH)

 **HALL BEOGRAD**

**10.00-11.30 UROGENITAL RADIOLOGY I**

**MODERATORS:**

DEMOSTHENIS COKKINOS (GR), SANJA STOJANOVIĆ (RS)

**1. CONTRAST ENHANCED ULTRASOUND OR CT FOR BOSNIAK CHARACTERISATION OF RENAL CYSTS**

DEMOSTHENIS COKKINOS (GR)

**2. RENAL LESION CHARACTERIZATION WITH MRI**

MUSTAFA SECIL (TR)

**3. THE RELEVANCE OF STONE DENSITY MEASUREMENT IN UROLYTHIASIS.**

BILJANA MARKOVIĆ (RS)

**4. OVARIAN CANCER - TIPS AND TRICS**

SANJA STOJANOVIĆ (RS)

**12.00-13.00 OPENING CEREMONY**

**MINISTRY OF HEALTH, REPUBLIC OF SERBIA**

PROF. DANICA GRUJIĆIĆ, MINISTER

**SERBIAN MEDICAL CHAMBER**

DR MIODRAG STANIĆ, DIRECTOR

**FACULTY OF MEDICINE, UNIVERSITY OF BELGRADE**

PROF. LAZAR DAVIDOVIĆ, DEAN

**BALKAN SOCIETY OF RADIOLOGY**

PROF. MILAN TOTEV, PRESIDENT

**SERBIAN SOCIETY OF RADIOLOGY**

PROF. RUŽICA MAKSIMOVIĆ, PRESIDENT

**HONORARY LECTURES**

**MODERATOR:**

PROF. N. GOURTZOYIANNIS (GR), PROF. RUZICA MAKSIMOVIC (RS),

PROF. MILAN TOTEV (BG)

“MENTORSHIP IN THE ERA OF AI”- PROF. N. GOURTZOYIANNIS (GR),

THE HISTORY OF THE FUTURE: AI & RADIOLOGY. - MILOS. A. LUCIC (RS)



**13.00-14.00 WELCOME COCTAIL** **HALL ATRIUM****14.00-15.30 ABDOMINAL RADIOLOGY****MODERATORS:**

NEVRA ELMAS (TR), DRAGAN VASIN (RS)

**1. SMALL BOWEL TUMORS**

NEVRA ELMAS (TR)

**2. IMAGING OF MESENTERIC ISCHAEMIA**

DRAGAN VASIN (RS)

**3. WHAT IS NEW IN THE STAGING OF COLON TUMORS**

EZGI GULER (TR)

**4. STENOSIS AND DILATATION OF THE WIRSUNG`S DUCT**

ALEKSANDAR BOJANOVIĆ (RS)

**5. DIAGNOSTIC CHALLENGES IN LIVER CIRRHOSIS - ARCHITECTURE OF DYSFUNCTION**

FLORIN MIHAI (RO)

**6. DUAL ENERGY CT: BASIC PRINCIPLES AND APPLICATIONS**

SAŠA VUJNOVIĆ (BIH)

 **HALL HORIZONT****14.00-15.30 INTERVENTIONAL RADIOLOGY I****MODERATORS:**

NIKOLAOS GALANAKIS (GR), VIKTOR TILL (RS)

**1. PERFUSION IMAGING IN PATIENTS WITH PERIPHERAL ARTERIAL DISEASE**

NIKOLAOS GALANAKIS (GR)

**2. OUR EXPERIENCE IN CAROTID ARTERY STENTING**

VIKTOR TILL (RS)

**3. THE UNIQUE PATHOBIOLOGY OF GIANT BRAIN ANEURYSM AND THEIR TREATMENT CHALLENGES**

MICHALIS MANTATZIS (GR)

**4. US AND CEUS IMAGING OF ENDOLEAKS IN THE POST-EVAR AORTA**

VASILEIOS RAFAILIDIS (GR)

## 14.00-15.30 SCIENTIFIC PRESENTATIONS

## INTERVENTIONAL RADIOLOGY, MUSCULOSKELETAL RADIOLOGY AND NEURORADIOLOGY

## MODERATORS:

NENAD JANESKI (SRB), RADIŠA VOJINOVIĆ (SRB)

**1. PERCUTANEOUS ASCITES DRAINAGE CATHETER PROCEDURE WITH THE SELDINGER METHOD: A SINGLE CENTER EXPERIENCE**

OMER FARUK ULUCA, MUSTAFA OZDEMIR (TR)

**2. ENDOVASCULAR AND PERCUTANEOUS TREATMENT PROCEDURES IN DIALYSIS FISTULA THROMBOSIS**

ERBIL ARIK, ONUR TAYDAŞ, ÖMER FARUK ATEŞ (TR)

**3. THE OUTCOME OF EMBOLIZATION OF NON-TRAUMATIC RECTUS SHEATH HEMATOMAS**

EDA CINGOZ, MEHMET CINGOZ (TR)

**4. SUCCESSFUL HYBRID APPROACH TREATMENT OF A LARGE PERSISTENT SCIATIC ARTERY ANEURYSM**

VLADIMIR CVETIĆ, BORIVOJE LUKIĆ, MARKO MILETIĆ, OLIVER RADMILI, BRANKO GAKOVIĆ (RS)

**5. SIGNIFICANCE OF PAIN DURATION BEFORE TREATMENT WITH CT GUIDED PERIRADICULAR THERAPY IN PATIENTS WITH SCIATICA**

D VELJANOVSKI, B PRGOVA, M KOSTOVA, S DEJANOVA, I JOVANOSKA (RNM)

**6. CT GUIDED PERIRADICULAR INFILTRATION TREATMENT IN PATIENT WITH EXTRA-FORAMINAL DISC HERNIATION**

D VELJANOVSKI, T DELEVA STOSHEVSKA, D RISTIK-STOMNAROSKA, G DUNGEVSKI (RNM)

**7. TOP 5 VERTEBRAL LOOKS AT ALL IMAGING MODALITIES YOU MAY NEED TO KNOW**

LJILJANA DRAZETIN, IVANA STOJIĆ (RS)

**8. DIFFERENT SUBCORTICAL VOLUME IN PATIENTS WITH TEMPORAL LOBE EPILEPSY**

Z. JOKOVIĆ, A. PEJOVIĆ, V. MILER JERKOVIĆ, A. RISTIĆ (RS)

**9. AN EXCESS ARTERY IN THE POSTERIOR SEGMENT OF THE CEREBRAL ARTERIAL CIRCLE IN HUMAN ADULT CADAVER**

MILENA TRANDAFILOVIĆ, MIROSLAV MILIĆ, ALEKSANDRA ANTOVIĆ, IVAN STOJANOVIĆ (RS)

**10. RADIOLOGICAL EVALUATION OF INTRACRANIAL ANEURYSMS AND AV MALFORMATIONS**

TIJANA KOKOVIĆ (RS)

**HALL ATRIUM**
**15.30-17.00 NEURORADIOLOGY I - MASTER CLASSES**
**MODERATORS:**

EFROSINI PAPADAKI (GR), EDWARD MICHELS (USA), TURGUT TALI (TR)

- 1. BRAIN TUMORS IMAGING: KNOWN AND UNKNOWN**  
EDWARD MICHALS (USA)
- 2. CURRENT AND FUTURE BIOMARKERS OF DISEASE ACTIVITY IN MULTIPLE SCLEROSIS**  
ZSIGMOND TAMÁS KINCSES (HU)
- 3. NON-MS IDIOPATHIC DEMYELINATING DISEASES (MOGAD, NMOSD, ETC.) AND DIFFERENTIAL DIAGNOSIS FROM MS**  
EFROSINI PAPADAK (GR)
- 4. UNCOVERING THE GLYMPHATIC SYSTEM**  
TURGUT TALI (TR)
- 5. HOW TOUGH IS THE TOUGH BODY?**  
MARTINA ŠPERO (CRO)

**HALL HORIZONT**
**15.30-17.00 CARDIOVASCULAR RADIOLOGY**
**MODERATORS:**

KOSTANTINOS MICHAILIDIS (GR), MILENA SPIROVSKI (RS), RUŽICA MAKSIMOVIĆ (RS)

- 1. CT EVALUATION OF THE AORTIC ROOT PATHOLOGIES**  
VIOLETA GROUDEVA (BG)
- 2. PLAQUE, HEAMODYNAMIC COMPOMISE AND ISCHAEMIA: THE ROLE OF CARDIAC CT**  
KOSTANTINOS MICHAILIDIS (GR)
- 3. ISCHEMIC HEART DISEASE: THE ROLE OF MRI**  
MILENA SPIROVSKI (RS)
- 4. MRI IN NON-ISCHEMIC HEART DISEASE**  
TUNCAY HAZIROLAN (TR)
- 5. CARDIAC MRI AS A RISK STRATIFICATION TOOL IN COVID 19 MYOCARDITIS**  
OLGA NEDELJKOVIĆ (RS)



## 15.30-17.00 SCIENTIFIC PRESENTATIONS

### ABDOMINAL RADIOLOGY AND URORADIOLOGY

#### MODERATORS:

DRAGAN DULOVIĆ (SRB), DUŠAN ŠAPONJSKI (SRB)

#### 1. BOWEL AND MESENTERIC TRAUMA – CT SIGNS, DIAGNOSTIC CHALLENGES AND PITFALLS

TIJANA TOMIĆ, DRAGAN VASIN, BILJANA JOVANDIĆ, SANELA HASANAGIĆ, MILICA MITROVIĆ, KSENIJA MIJOVIĆ, DRAGAN MAŠULOVIĆ (RS)

#### 2. BENIGN PANCREATIC LESIONS MIMICKING MALIGNANCY - A CASE SERIES

JOVANA MILENKOVIĆ, MILICA STEVANOVIĆ, JELENA KOVAČ (RS)

#### 3. SOLID PSEUDOPAPILLARY NEOPLASM OF THE PANCREAS AND THE ROLE OF MRI IN THE DIAGNOSIS: A CASE SERIES

MILICA STEVANOVIĆ, JOVANA MILENKOVIĆ, JELENA KOVAČ (RS)

#### 4. INTRADUCTAL PAPILLARY NEOPLASM OF THE BILE DUCT (IPNB): CT AND MRI CHARACTERISTICS FOR DETECTION OF RARE PATHOLOGICAL ENTITY

STEFAN MILOSEVIĆ, KATARINA STOŠIĆ, MILICA MITROVIĆ, ALEKSANDRA JANKOVIĆ, DUŠAN ŠAPONJSKI, LJUBICA LAZIĆ, ALEKSANDRA ĐURIC-STEFANOVIĆ, JELENA KOVAČ (RS)

#### 5. RADIOLOGICAL PRESENTATION OF ABDOMINAL WALL HERNIAS: A COMPREHENSIVE OVERVIEW

STEFAN MILOŠEVIĆ, ALEKSANDRA ĐURIC-STEFANOVIĆ, KATARINA STOŠIĆ, MILICA MITROVIĆ-JOVANOVIĆ, DUSAN ŠAPONJSKI, ALEKSANDRA JANKOVIĆ, JELENA KOVAČ, LJUBICA LAZIĆ (RS)

#### 6. PANCREATIC CYSTIC LESIONS, OUR EXPERIENCES

VLADIMIR VIDENOVIĆ, TAMARA VUČINIĆ (RS)

#### 7. THE IMPORTANCE OF DIAGNOSTIC MONITORING OF PATIENTS WITH ACUTE PANCREATITIS AND TIMELY DETECTION OF LIFE-THREATENING VASCULAR COMPLICATIONS: SINGLE CENTER EXPERIENCE

KATARINA STOŠIĆ, STEFAN MILOSEVIĆ, ALEKSANDRA ĐURIC-STEFANOVIĆ, JELENA KOVAČ, DRAGAN MAŠULOVIĆ, MILICA MITROVIĆ, DUŠAN ŠAPONJSKI, ALEKSANDRA JANKOVIĆ, LJUBICA LAZIĆ, BORIVOJE LUKIĆ, VLADIMIR CVETIĆ (RS)

#### 8. THE RELATIONSHIP BETWEEN PIRADS v2.1 AND GLEASON SCORE IN THE DIAGNOSIS OF PERIPHERAL ZONE PROSTATE CANCER BY ADC HISTOGRAM ANALYSIS

HALIL İBRAHİM SARA, HASAN AYDIN, FATİH HIZLI (TR)

#### 9. THE ROLE OF T2W PULSE SEQUENCE AND DIFFUSION WITH ITS NUMERICAL ADC MAP IN PROSTATE CANCER DIAGNOSIS

M KOSTOVA, A DODEVSKI, D VELJANOVSKI, B ZAFIROVSKA-IVANOVSKA, S DEJANOVA PANEV, B PRGOVA VELJANOVA (RNM)

#### 10. PI-RADS CLASSIFICATION

MAJA STANKOV, IVANA STOJIĆ, IVAN ADJIĆ, MARIJANA BASTA NIKOLIĆ, NATAŠA PRVULOVIĆ BUNOVIĆ (RS)

**17.00-17.30 BREAK**

 **HALL ATRIUM**

**17.30-19.00 NEURORADIOLOGY II HOW DO I EXAM: QUICK TIPS AND TRICKS IN A COUPLE OF MINUTES**

**MODERATORS:**

CEM CALLI (TR), BILJANA GEORGIEVSKI BRKIĆ (RS), MILOŠ LUČIĆ (RS),  
KATARINA KOPRIVŠEK (RS)

**1. HOW DO I EXAM: PRE – AND POSTTREATMENT BRAIN TUMORS:  
THE QUADRANGULATION**

CEM CALLI (TR) KAMIL KARAALI (TR)

**2. HOW DO I EXAM: ACUTE STROKE**

BILJANA GEORGIEVSKI BRKIĆ (RS)

**3. HOW DO I EXAM: NEUROINFLAMATION**

SVJETLANA JEFIĆ (BIH)

**4. HOW DO I EXAM: EPILEPSY**

KATARINA KOPRIVŠEK (RS)

**5. HOW DO I EXAM: SMALL VESSEL DISEASE**

JASMINA BOBAN (RS)

**6. HOW DO I EXAM: CEREBRAL VENOUS THROMBOSIS**

MARIJA JOVANOVIĆ (RS)

**7. HOW DO I EXAM: DEGENERATIVE SPINE**

DEJAN KOSTIĆ (RS)

**8. HOW DO I EXAM: INTRACRANIAL CYSTIC LESIONS**

MARIJANA KARLOVIĆ VIDAKOVIĆ (BIH)

**9. HOW DO I EXAM: HYDROCEPHALUS**

MILOŠ LUČIĆ (RS)

 **HALL HORIZONT**

**17.30-19.00 ONCOLOGY IMAGING I (STRUCTURED REPORT)**

**MODERATOR:**

SOFIA GOURTZOYIANNI (GR), SILVIJA LUČIĆ (RS)

**1. STRUCTURED REPORTING IN GYNECOLOGICAL CANCER**

CHARIS BOURGIOTI (GR)

**2. ANAL CANCER: MRI STAGING**

SOFIA GOURTZOYIANNI (GR)

**3. ESSENTIAL FINDINGS FOR STRUCTURED REPORTING OF RECTAL CANCER MRI**

BENGI GURSES (TR)

**4. THE IMPORTANCE OF STRUCTURED REPORT IN PANCREATIC CANCER**

EVANGELOS CHARTABILAS (GR)



## 17.30-19.00 SCIENTIFIC PRESENTATIONS

### BREAST, CHEST IMAGING, HEAD AND NECK IMAGING

#### MODERATORS:

MILOŠ GAŠIĆ (RS), SINIŠA RISTIĆ (BiH)

1. **INTERVAL BREAST CANCERS DETECTED IN THE SCREENING MAMMOGRAPHY PROGRAM AT THE OBRENOVAC HEALTH CENTER**  
PREDRAG JOVANOVIĆ, MILOŠ PEKOVIĆ (RS)
2. **UNUSUAL PRESENTATIONS OF LUNG CARCINOMA - CASE REPORTS**  
RADE KOVAČ, NATAŠA KNEŽEVIĆ, MARIJA STOLIĆ (RS)
3. **FEASIBILITY OF USING CROSS-SECTIONAL AREA OF MASTICATORY MUSCLES TO PREDICT SKELETAL MUSCLE SARCOPENIA IN HEALTHY AGING SUBJECTS**  
ALEKSA JANOVIĆ, BILJANA MILIČIĆ, SVETLANA ANTIĆ, ĐURĐA BRACANOVIĆ, MARIJANA STANIŠIĆ, GORAN KRSTIĆ, BILJANA MARKOVIĆ-VASILJKOVIĆ (RS)
4. **CT AND CT IMAGE-BASED TEXTURE IMAGE ANALYSIS IN RADIOLOGICAL EVALUATION OF CHRONIC RHINOSINUSITIS**  
ĐURĐA BRACANOVIĆ, SVETLANA ANTIĆ, ALEKSA JANOVIĆ, GORAN KRSTIĆ, MARIJANA STANIŠIĆ, BILJANA MARKOVIĆ VASILJKOVIĆ (RS)
5. **COMPUTED TOMOGRAPHY EVALUATION OF SINONASAL POLYPOSIS**  
GORAN KRSTIĆ, MARIJANA STANIŠIĆ, ĐURĐA BRACANOVIĆ, ALEKSA JANOVIĆ, SVETLANA ANTIĆ, BILJANA MARKOVIĆ VASILJKOVIĆ (RS)
6. **DIAGNOSTIC VALUE OF ULTRASOUND-BASED DEEP LEARNING IN CLASSIFICATION OF BENIGN-MALIGN THYROID NODULES**  
MERVE SOLAK, ESAT KABA, AYŞENUR TOPÇU VARLIK, YUSUF ÇUBUKÇU, LÜTFULLAH SAĞIR, KUBILAY MUHAMMED SÜNNETCI, AHMET ALKAN, HASAN GÜNDOĞDU, FATMA BEYAZAL ÇELIKER, MEHMET BEYAZAL (TR)
7. **ACTIVE SURVEILLANCE OR SURGERY FOR ACR TI RADS 5 NODULES MESURING LESS THAN 1CM: IS PAPILLARY MICROCARCINOMA REALLY INDOLENT?**  
PREDRAG JOVANOVIĆ, MILOŠ PEKOVIĆ, VESNA KOVAČEVIĆ (RS)
8. **COMPARISON OF COMPUTED TOMOGRAPHY AND INTRAORAL ULTRASONOGRAPHY IN ASSESSING THE INVASION DEPTH OF ORAL SQUAMOUS CELL CARCINOMA**  
SVETLANA ANTIĆ, ĐURĐA BRACANOVIĆ, ALEKSA JANOVIĆ, MARIJANA STANIŠIĆ, GORAN KRSTIĆ, BILJANA MARKOVIĆ VASILJKOVIĆ (RS)
9. **INITIAL CLINICAL EXPERIENCES WITH THE USE OF CO<sub>2</sub> CONTRAST MEDIA DURING INTERVENTIONAL RADIOLOGICAL PROCEDURES**  
STEFAN PETKOVIĆ, SAŠA VUJNOVIĆ, BOJAN JOVANIĆ, MILE ČUČAK (BiH)
10. **ANTHROPOMETRIC CHARACTERISTICS OF THE FACIAL SOFT TISSUE THICKNESS AND IT'S SIGNIFICANCE IN FORENSIC MEDICINE**  
TAMARA TAPUŠKOVIĆ, DRAGOSLAV NENEZIĆ, RABINA DEDEIĆ (MNE)

19.00-20.00 BSR EXECUTIVE COMMITTEE MEETING & GENERAL ASSEMBLY

21.00 GET TOGETHER AND NETWORKING

**FRIDAY, OCTOBER 20, 2023**

 **HALL ATRIUM**

**08.00-09.30 CHEST IMAGING**

**MODERATORS:**

KIRIAKI TAVERNARAKI (GR), RUŽA STEVIĆ (RS)

**1. LUNG CANCER SCREENING WITH LOW DOSE CT. AN OVERVIEW**

KIRIAKI TAVERNARAKI (GR)

**2. IMAGING OF THE PULMONARY NODULES**

SELEN BAYRAKTAROGLU (TR)

**3. THE MANY FACES OF PULMONARY SARCOIDOSIS DETECTED ON HRCT  
- OUR EXPERIENCE**

KRISTINA DIMITRIJEVIKI (RNM)

**4. CTPA BEYOND PULMONARY EMBOLISM- THE PULMONARY ARTERIAL  
OBSTRUCTION INDEX**

SONJA NIKOLOVA (RNM)

 **HALL HORIZONT**

**08.00-09.30 UNDERSTANDING IMAGING FUNDAMENTALS**

**MODERATOR:**

D. AKATA (TR), MARIJA BASTA NIKOLIĆ (RS)

**1. PERITONEUM AND MESENTERY**

PANOS PRASSOPOULOS (GR)

**2. MRI OF SHOULDER JOINT-ANATOMY AND BASIC KNOWLEDGE**

MILOŠ GAŠIĆ (RS)

**3. UNDERSTANDING BREAST IMAGING**

MARIJA BASTA NIKOLIĆ (RS)

**4. MRI OF THE SPINE: HOW TO RECOGNIZE AND REPORT**

JELENA KOSTIĆ (RS)

**5. HOW TRAINEES (SHOULD) LEARN ANATOMY BY NEUROIMAGING**

INTESAR-VICTORIA MALLA (BG)

 **HALL BEOGRAD**
**08.00-09.30 HEAD AND NECK RADIOLOGY****MODERATORS:**

NIKOLETA TRAYKOVA (BG), SLADJANA PETROVIĆ (RS)

**1. SUPRAHYOID NECK SPACES- ANATOMY AND PATHOLOGY**

NIKOLETA TRAYKOVA (BG)

**2. IMAGING OF PERINEURAL TUMORAL SPREAD IN HEAD AND NECK**

SLADJANA PETROVIĆ (RS)

**3. LYMPHOMA IN HEAD AND NECK**

CAN KARAMAN (TR)

**4. MUST KNOW PSEUDOLESIONS IN HEAD AND NECK**

DARKA HADNAĐEV-ŠIMONJI (RS)

 **HALL ATRIUM**
**09.30-11.00 FOCUS SESSION II: PROSTATE CANCER - WHAT SHOULD I KNOW?****MODERATORS:**

RUŽICA MAKSIMOVIĆ (RS), TOMISLAV PEJČIĆ (RS)

**1. PROSTATE CANCER: WHAT RADIOLOGIST SHOULD KNOW?**

TOMISLAV PEJČIĆ (RS)

**2. DIAGNOSTIC VALUE OF MPMR IN EVALUATION OF PROSTATE CANCER: ARE WE HAPPY?**

RUŽICA MAKSIMOVIĆ (RS)

**3. ONCOLOGY APPROACH – WHAT A RADIOLOGIST SHOULD KNOW?**

SUZANA STOJANOVIĆ RUNDIĆ (RS)

**4. PROSTATE CANCER THERANOSTICS**

MILOŠ VELJKOVIĆ (RS)

 **HALL HORIZONT**
**09.30-11.00 MUSKULOSKELETAL RADIOLOGY II****MODERATORS:**

ZULEJHA MERHEMIĆ (BIH), VESNA NJAGULJ (RS)

**1. SPINAL BONE TUMORS**

SEBNEM ORGUC (TR)

**2. INFECTIONS OF THE SPINE**

ZULEJHA MERHEMIĆ (BIH)



**3. IMAGING OF THE PUBIC SYMPHYSIS**

MUJDAT BANKAOĞLU (TR)

**4. DIFFERENTIAL DIAGNOSIS OF SEPTIC ARTHRITIS**

NURAN SABIR (TR)

**HALL BEOGAD****09.30-11.00 EMERGENCY RADIOLOGY****MODERATORS:**

VESNA SARAJLIĆ (BIH), DEJAN JOVANOVIĆ (RS)

**1. BLUNT ABDOMINAL TRAUMA**

VESNA SARAJLIC (BIH)

**2. UP-TO-DATE IMAGING OF THE CERVICAL TRAUMA**

NAIL BULAKBASI (TR)

**3. INFLAMMATION AND ATHEROSCLEROSIS THROUGH THE EYES OF RADIOLOGY**

MARIA NEDEVSKA (BG)

**4. CALM NIGHT FOR AN EMERGENCY RADIOLOGIST**

DEJAN JOVANOVIĆ (RS)

**11.00-11.30 BREAK****HALL ATRIUM****11.30-1300 HEPATOBILIARY RADIOLOGY II****MODERATORS:**

CHARINA TRIANTOPOULOU (GR), ALEKSANDAR IVANOVIĆ (RS), JELENA ĐOKIĆ KOVAČ (RS)

**1. IMAGING IN OBSTRUCTIVE JAUNDICE**

ALEKSANDAR SPASIĆ (RS)

**2. CANCERS OF THE AMPULLA VATER**

ALEKSANDAR IVANOVIĆ (RS)

**3. MIMICS OF GALLBLADDER ADENOCARCINOMA**

SOFIA PAPAIOANNOU (GR)

**4. CHRONIC PANCREATITIS: A PATH TO PANCREATIC CANCER**

MILICA MITROVIĆ (RS)

**5. DIFFERENTIAL DIAGNOSTIC CLUES FOR PANCREATIC TUMORS**

CHARINA TRIANTOPOULOU (GR)

 **HALL HORIZONT**
**11.30-13.00 MY MOST CHALLENGING CASES -****MODERATORS:**

LUKAS DAGDILELIS (GR), KATERINA XINOU (GR), KSENIJA MIJOVIĆ (RS)

1. LUKAS DAGDILELIS (GR)
2. KATERINA XINOU (GR)
3. DUŠAN ŠAPONJSKI (RS)
4. KSENIJA MIJOVIĆ (RS)
5. SMILJANA KOCIĆ (RS)
6. ALEKSANDAR PAVLOVIĆ (RS)

 **HALL BEOGRAD**
**11.30-13.00 INTERVENTIONAL RADIOLOGY II****MODERATOR:**

OKAN AKHAN (TR), JOVICA ŠAPONJSKI (RS)

1. **HCC: THE ROLE OF LOCAL ABLATION**  
OKAN AKHAN (TR)
2. **ENDOVASCULAR TREATMENT OF EXTRACRANIAL CAROTID ARTERY DISEASE**  
VLADIMIR CVETIĆ, BORIVOJE LUKIĆ (RS)
3. **TREATMENT OF VASCULAR PANCREATIC LESIONS**  
DAVOR MRDA (RS)
4. **EFFECTS OF OXYGEN OZON THERAPY OF LOW BACK PAIN-THREE YEARS FOLLOW UP**  
KRISTINA DAVIDOVIĆ (RS)

**13.00-14.00 BREAK**
 **HALL ATRIUM**
**14.00-15.30 BREAST IMAGING II****MODERATOR:**

VANESA BEŠLAGIĆ (BIH), MIRJAN NADRLJANSKI (RS), DIJANA NIĆIFOROVIĆ (RS)

1. **IMAGING OF THE HIGH-RISK PREMALIGNANT BREAST LESIONS**  
AYŞENUR OKTAY (TR)
2. **BI-RADS 3 LESIONS: DIAGNOSTIC EVALUATION**  
VANESA BEŠLAGIĆ (BIH)

**3. NEEDLE LOCALIZATION OF BREAST LESIONS**

MAJA JAKIMOVSKA DIMITROVSKA (RNM)

**4. MRI AND CESM-GUIDED BIOPSY: ADVANTAGES AND CHALLENGES IN ROUTINE USE**

MIRJAN NADRLJANSKI (RS)

**HALL HORIZONT****14.00-15.30 FOCUS SESSION III: LUNG CANCER: WHAT SHOULD I KNOW?****MODERATORS:**

RUŽA STEVIĆ (RS), DRAGANA ŠOBIĆ ŠARANOVIĆ (RS)

**1. ATYPICAL PRESENTATIONS OF LUNG CARCINOMA**

RUŽA STEVIĆ (RS)

**2. TNM CLASSIFICATION OF LUNG CANCER-PITFALLS AND LIMITATIONS**

DRAGAN DRAGIŠIĆ (RS)

**3. THE ROLE OF PET CT IN THE LUNG CANCER STAGING**

DRAGANA ŠOBIĆ ŠARANOVIĆ (RS)

**4. RECIST 1.1 CRITERIA IN LUNG CANCER RESPONSE EVALUATION**

VESNA STOKANOVIĆ (RS)

**5. RADIOLOGICAL TREATMENT OF OLIGOMETASTATIC LUNG CANCER**

BILJANA ŠEHA (RS)

**HALL BEOGRAD****14.00-15.30 UROGENITAL RADIOLOGY II****MODERATORS:**

DENIZ AKATA (TR), OLIVERA NIKOLIĆ (RS)

**1. DEEP ENDOMETRIOSIS**

DENIZ AKATA (TR)

**2. BIPARAMETRIC PROSTATE MRI**

ATADAN TUNACI (TR)

**3. US EVALUATION OF VARICOCELE: RECOMMENDATIONS OF THE ESUR SPIWG**

ATHINA TSILI (GR)

**4. CYSTIC FEMALE PELVIC MASSES**

OLIVERA NIKOLIĆ (RS)

 **HALL ATRIUM**

**15.30-17.00 JRF / RTF - A SHIFT IN A DAY / NIGHT OF RADIOLOGIST**

**MODERATORS:**

VESNA NJAGULJ (RS), MILENA SPIROVSKI (RS), KRISTINA IVOŠEVIĆ (RS)

1. RADMILA PERIĆ (RS)

2. SLOBODAN TORBICA (RS)

3. IVANA STOJIĆ (RS)

4. ALEKSANDAR RAGAJI (RS)

5. STEFAN STOJANOSKI (RS)

6. KRISTINA POLAK (RS)

7. UROŠ MIRČIĆ (RS)

8. IVAN ANDJELKOVIĆ (RS)

9. VESNA BABIĆ (RS)

10. MAJA POPOVIĆ (RS)

11. JOVANA TONČEV (RS)

 **HALL HORIZONT**

**15.30-17.00 HANDS ON IN MSK**

 **HALL BEOGRAD**

**15.30-17.00 ONCOLOGY IMAGING II**

**MODERATORS:**

NIKOLAOS COURCOUTSAKIS (GR), SILVIJA LUČIĆ (RS)

**1. FINDINGS OF PERITONEAL CARCINOMATOSIS IN THE SMALL BOWEL: RADIOLOGIC – PATHOLOGIC CORRELATION**

NIKOLAOS COURCOUTSAKIS (GR)

**2. REGIONAL LYMPHADENOPATHY IN HEAD AND NECK CANCER - WHAT, WHERE AND WHY?**

SVETLA DINEVA (BG)

**3. PET/CT IN ONCOLOGY**

SILVIJA LUČIĆ (RS)

**4. MR IMAGING IN 3D BRACHYTHERPY FOR CERVICAL CARCINOMA**

ALEKSANDAR TOMAŠEVIĆ (RS)

 **HALL BEOGRAD**

**17.30-18.00 CLOSING CEREMONY AND AWARDS**

## THE MANY FACES OF PULMONARY SARCOIDOSIS DETECTED ON HRCT- OUR EXPERIENCE

KRISTINA DIMITRIJEVIC (RNM)

### Introduction:

Sarcoidosis is a multisystemic disease of unknown etiology that mostly affects the lung parenchyma with interstitial and granulomatous changes of varying intensity and expression depending on the stage of the disease.

### The aim of the study:

To analyze the distribution and characteristics of interstitial lung lesions as well as atypical variants of sarcoidosis and the involvement of mediastinal lymph nodes with high resolution computed tomography.

### Material and methods:

In our study 25 patients diagnosed with sarcoidosis were included. HRCT was made on a 128 slice CT scanner PHILIPS INCISIVE, using 1 mm thickness of section and high spatial frequencies algorithm for image reconstruction. Lymph nodes are classified as hilar and mediastinal. Pulmonary changes are classified as nodules, reticular opacities, fibrous lesions, ground-glass opacities and consolidations. The disease is graded in 5 stages with the Scadding classification.

### Results:

We analyzed 25 patients with sarcoidosis, all of whom are woman in the age group of 30-60 years. 2 patients each are in stage I and III of the disease, 12 patients are in stage II of sarcoidosis and 9 are in stage IV of the disease. Dry cough as a symptom predominates in all patients, while dyspnea is graded according to the mMRC scale. Mediastinal lymphadenopathy with and without calcifications was present in 18 patients.

### Conclusion:

HRCT is the method of choice in the evaluation of pathological changes in pulmonary sarcoidosis. It very precisely show us the characteristic appearance of nodules and lesions, their distribution and atypical changes and help us in grading the disease and its treatment.

### Key words:

lung, sarcoidosis, interstitial lung disease, HRCT

## CTPA BEYOND PULMONARY EMBOLISM- THE PULMONARY ARTERIAL OBSTRUCTION INDEX

SONJA NIKOLOVA, (RNM)

Pulmonary thromboembolism (PTE) and deep vein thrombosis (DVT) are different manifestations of the same condition, venous thromboembolism (VTE), which is the third most common cardiovascular disease after the ischemic heart and cerebrovascular diseases. Thus, we have to be mindful that acute pulmonary embolism (APE) is a medical emergency and a very serious clinical manifestation of VTE, that occurs due to discharge of emboli in the pulmonary arterial system which leads in subsequent arterial occlusion and an increase in the pulmonary vascular resistance, an increase in the right heart afterload and acute right ventricular failure, which is a life- threatening condition. Taking into account the fact that patients with right heart dysfunction have a high mortality rate, timely diagnosis and prompt management are the basis for the reversibility of the condition.

The significantly improved image quality and upgraded diagnostic performance of CT pulmonary angiography are essential in acknowledging this diagnostic modality as the imaging technique of choice in suspected pulmonary embolism. The last decade has shown a dramatic improvement in the CTPA depiction quality of the pulmonary vasculature, and through additional enabling of the PAOI calculation, offers a quantitative value to the severity of APE, as well as detailed assessment of RV function.

The objective of this lecture is not only to confirm the importance of CTPA in the prompt diagnosis of APE, but also to help radiologists conduct a detailed assessment of the CTPA's in patients with APE, and by evaluating the relationship between the pulmonary arterial obstruction index (PAOI) and several CT cardiovascular markers of right heart dysfunction, to determine its prognostic value in the risk stratification of potential RHD. Besides confirming the prognostic value of CTPA in predicting possible complications, we also want to make a meaningful contribution into the decision making of the APE management, in forming an interdisciplinary consensus regarding follow up CTPA protocols in patients with PTE, and through the evaluation of PAOI and PAOI- associated right ventricular dysfunction, to optimize the duration of therapy and avoid unnecessary imaging examinations, i.e., over- diagnosis.

#### **MRI OF SHOULDER JOINT-ANATOMY AND BASIC KNOWLEDGE**

MILOŠ GAŠIĆ, (SRB)

The shoulder joint is one of the most mobile joints, but with little stability. The aim of this lecture is to show the basic soft tissue structures on MR images, on different sections, as well as to show the anatomical static and dynamic stabilizers of the shoulder joint.

From the static stabilizers, the anatomical position, characteristics and varieties of Lig. coracoacromiale, Fossa glenoidalis & cartilage, Caput humeri & cartilage, Labrum glenoidale, Ligamenta, Tendo m.biceps brachii, Joint capsule, as well as some of the most common pathological conditions of these structures will be shown.

This lecture will also include a description of the rotator cuff muscles, with the most common pathological conditions and their characteristics on MR imaging.

MRI of the shoulder joint is the most reliable diagnostic modality for examining pathological conditions. Due to the comprehensive presentation of anatomical details as well as non-conclusive echo findings, MRI represents the method of choice in the diagnostic algorithm of examination

#### **MRI OF THE SPINE: HOW TO RECOGNIZE AND REPORT**

JELENA KOSTIC, DRAGAN MAŠULOVIĆ, RUŽICA MAKSIMOVIĆ, (SRB)

##### **Aim:**

By sharing our collective experience through interesting patient cases, we can make a real difference in how people are imaged and diagnosed.

##### **Material and methods:**

Approximately 3 % of patients who present to the emergency department as the result of a motor vehicle accident or fall have a major injury to the cervical spine. 10-20% patients with head injury also have a cervical spine injury. Up to 17% of patients have a missed or